

QuickFit™ Rekeyable Trim Plate Installation

202220918

First, take your new rekeyable trim plate to a locksmith to be rekeyed.

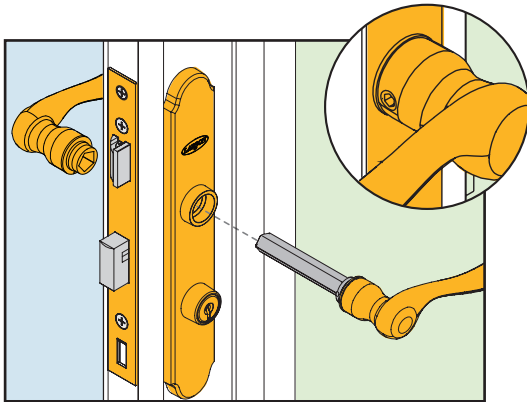

1. Open door and use deadbolt knob to extend deadbolt. Loosen handle set screw with 1/8" Allen wrench and remove interior and exterior handles.

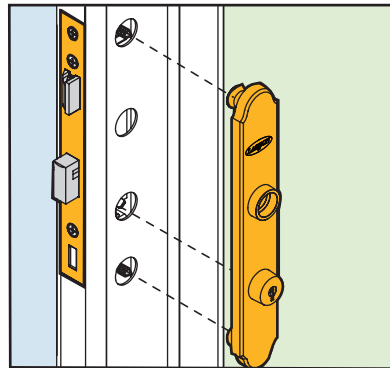

2. Loosen interior face plate screws, and remove interior and exterior face plates.
NOTE: Hole pattern may vary from illustration.

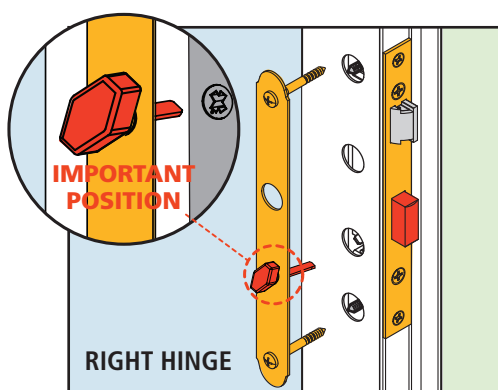

3. With deadbolt extended and deadbolt knob in position shown, insert deadbolt spindle through lock body, and insert interior face plate screws through door.

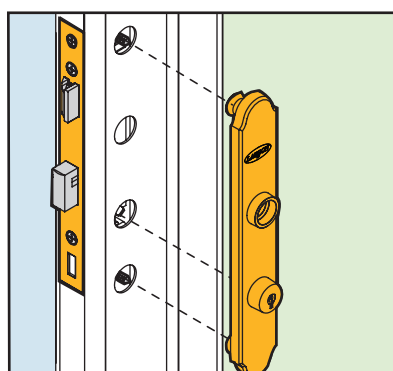
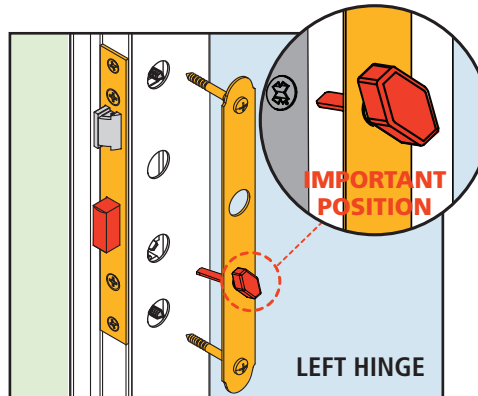

4. Align funnels on exterior face plate with screws, insert deadbolt spindle into key cylinder, and loosely finger-tighten the screws.

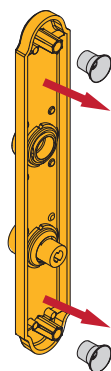

If the funnels on the replacement plate do not fit through the holes in the door remove the funnels by pulling them off.

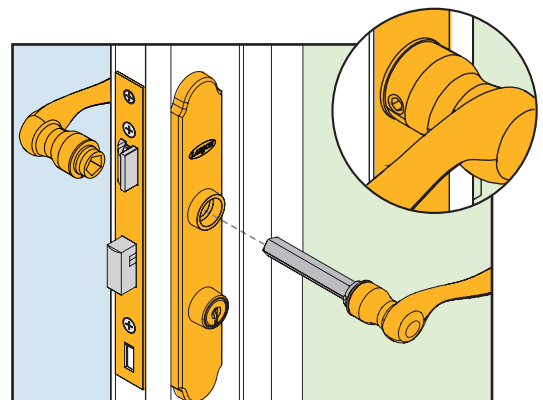

5. Insert handle spindle through lock body and into opposite handle. Tighten set screw with 1/8" Allen wrench. Tighten interior face plate screws.
Use deadbolt knob to retract deadbolt.
Maintain proper operation of your door hardware by periodically checking mounting screws and set screw for tightness.