

WOODCORE RETAINER INSTALLATION

Insert the printed leg into the groove. There are two grooves, use the one nearest to you.

Start at one end and work your way to the other end. Continue to push it in 4" to 5" increments.

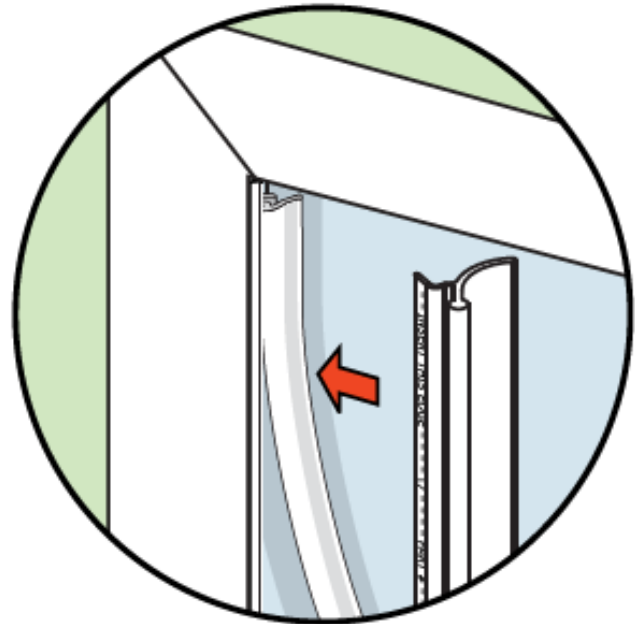
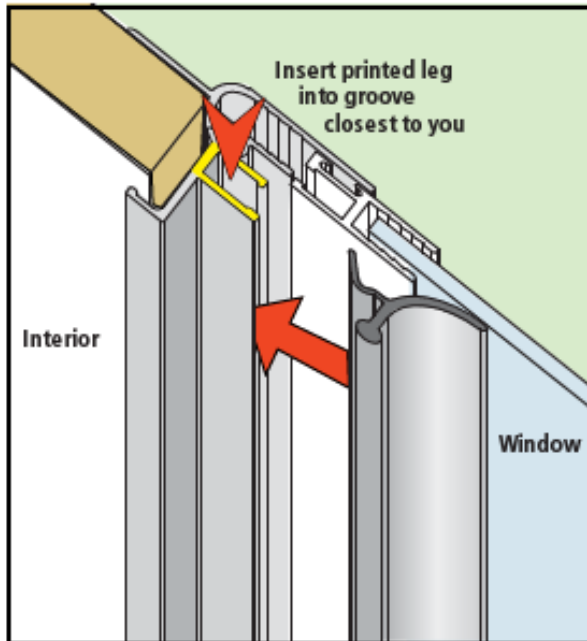

TO REMOVE THE RETAINER

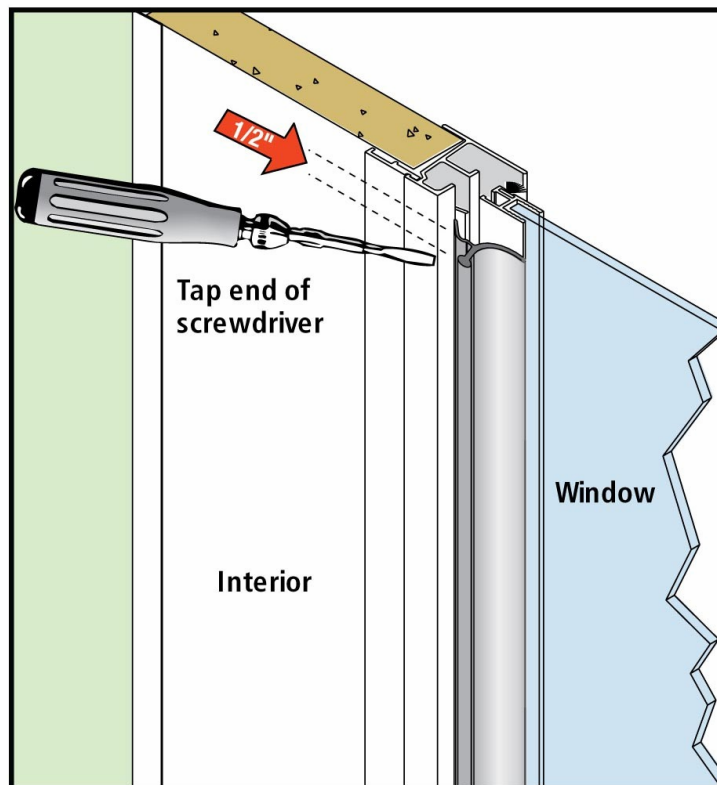

Tap one end of the Retainer loose with a flat-head screw driver 1/2" down from the top.

Once started, grab the end with your hand and gently pull the remaining the Retainer Strip out of the door.